

# PARTS VIEW

## KF26 & KK36 - PAN 19 DISC BRAKE AXLE

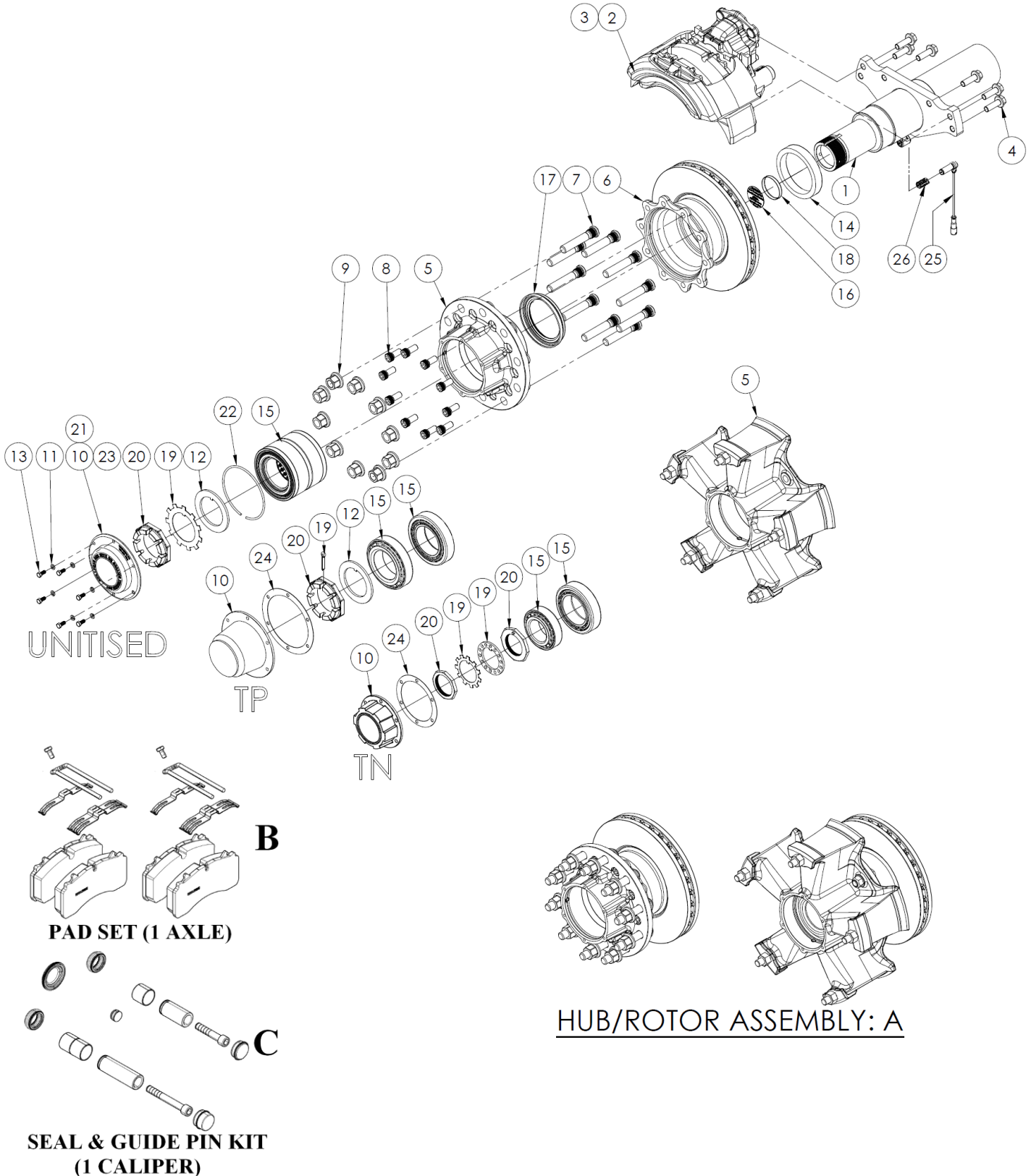

HUB/ROTOR ASSEMBLY: A

**IMAGES FOR ILLUSTRATION PURPOSES ONLY**



# PARTS VIEW

Ref No.	PART No.	DESCRIPTION	APPLICATION									
			<b>BEAM OPTIONS</b>									
			QUANTITY PER AXLE	1850			1820					
				TN	TP	UNITISED	TN	UNITISED				
1	KF26AX12X1850N	BEAM	1	X								
1	FP20DB0100	BEAM 8 & 10 Stud	1		X							
1	FP20DB0200	BEAM 5 Spoke	1		X							
1	FU20DB0100	BEAM 8 & 10 Stud	1			X						
1	FU20DB0200	BEAM 5 Spoke	1			X						
1	KF26AX12X1820N	BEAM	1				X					
1	FU20DB0100-1820	BEAM	1					X	X			
			<b>CALIPER</b>									
			QUANTITY PER AXLE	PAN 19 DISC BRAKE								
2	6401951090	CALIPER – LH	1					X				
3	6401951100	CALIPER – RH	1					X				
4	B30-0102	BOLT	12					X				
B	12999737	PAD SET	1					X				
C	12999776	CALIPER SEAL/GUIDE PIN KIT	2					X				
			<b>HUB OPTIONS</b>									
			QUANTITY PER AXLE	10x285			10x335		8x275		5 SPOKE	
				TN	TP	UNITISED	TN	UNITISED	TN	UNITISED	TP	UNITISED
5	FW429	HUB	2	X								
5	FW431	HUB	2		X							
5	FW473	HUB	2			X						
5	FW443	HUB	2				X					
5	FW444	HUB	2				X					
5	FW428	HUB	2					X				
5	FW497	HUB	2						X			
5	FW336	HUB	2							X		
5	FW352	HUB	2								X	
6	BC8433	ROTOR PAN 19 – 8 bolt	2	X			X		X			
6	H32-D102	ROTOR PAN 19 – 10 bolt	2		X							
6	BC8434	ROTOR PAN 19 – 10 bolt	2			X	X					
6	BC8439	ROTOR PAN 19 – 8 bolt	2						X			
6	BC8435TP	ROTOR PAN 19 – 5 bolt	2							X		
6	BC8435	ROTOR PAN 19 – 5 bolt	2								X	

# PARTS VIEW

Ref No.	PART No.	DESCRIPTION	APPLICATION									
			HUB OPTIONS									
			QUANTITY PER AXLE	10x285			10x335		8x275		5 SPOKE	
TN	TP	UNITISED		TN	UNITISED	TN	UNITISED	TP	UNITISED			
7	KH800104 (Note 1)	STUD SHORT (M22x94mm)	→	20	20	20	20	20	16	16		
7	KH800239 (Note 1)	STUD LONG (M22x122mm)	→	20	20	20	20	20	16	16		
8	KHDB012	BOLT HUB-ROTOR M14x1.5	→	16			16		16			
8	KHDB014	BOLT HUB-ROTOR M16x2	→			20		20		16		
8	KHDB015	BOLT HUB-ROTOR M12x1.75	→		20							
9	KH800238 (Note 2)	NUT STD (Std .33mm on Disc)	20	X	X	X	X	X	X	X		
10	KHALU01	HUB CAP – Ø139.7PCD	2	X			X		X			
10	KH340-4322	HUB CAP – Ø179PCD	2		X						X	
10	KH1897	HUB CAP – Ø179PCD	2			X		X		X		X
11	KH800055	WASHER – HUB CAP BOLT	12	X	X	X	X	X	X	X	X	X
12	KH800021	WASHER BEARING	2		X	X		X		X	X	X
13	KH800122	BOLT – HUB CAP	12	X	X	X	X	X	X	X	X	X
14	N300200-002	SEAL SHIELD	2			X		X		X		X
15	BTH-0053	BEARING CARTRIDGE (11T)	2			X		X		X		X
15	H12-0400	BEARING OUTER	2	X			X		X			
15	H12-0100	BEARING INNER	2		X						X	
15	H12-0300	BEARING INNER	2	X			X		X			
15	H12-0100	BEARING OUTER	2		X						X	
16	FHD-046	DECAL	2			X		X		X		X
17	373-0243 (802)	SEAL	2	X			X		X			
17	801 (373-0223)	SEAL	2		X						X	
17	809	SEAL (HI-TEMP)	2			X		X		X		X
18	STP275	DECAL CAP	2			X		X		X		X
19	KH800040	COTTER PIN	2		X						X	
19	KH800123	LOCK TAB	2	X			X		X			
19	KHLOCKTAB	LOCK TAB	2			X		X		X		X
19	KH800108	LOCK WASHER	2	X			X		X			
20	KH800020SG	NUT SPINDLE	2		X	X		X		X	X	X
20	KH800109	NUT SPINDLE – INNER	2	X			X		X			
20	KH800111	NUT SPINDLE – OUTER	2	X			X		X			
21	10002	FUWA BADGE	2			X		X		X		X
22	CRS.S	SNAP RING	2			X		X		X		X
23	KH1897-OR	O-RING – HUB CAP	2			X		X		X		X
24	KH330-3009	GASKET – HUB CAP	2	X			X		X			
24	KH3303118	GASKET – HUB CAP	2		X						X	
25	A15-0101	ABS SENSOR LEAD (400mm)	2	X	X	X	X	X	X	X	X	X
26	A16-0101	SLEEVE	2	X	X	X	X	X	X	X	X	X

# PARTS VIEW

Ref No.	PART No.	DESCRIPTION	APPLICATION									
			HUB OPTIONS									
			QUANTITY PER AXLE	10x285			10x335		8x275		5 SPOKE	
TN	TP	UNITISED		TN	UNITISED	TN	UNITISED	TP	UNITISED			
A	WHCT569AD	HUB / ROTOR ASSY.	2	X								
A	WHCT524AD	HUB / ROTOR ASSY.	2		X							
A	FWA473-01	HUB / ROTOR ASSY.	2			X						
A	WHCT592AD	HUB / ROTOR ASSY.	2				X					
A	WHCT744AD	HUB / ROTOR ASSY.	2					X				
A	WHCT570AD	HUB / ROTOR ASSY.	2						X			
A	WHCT744AD	HUB / ROTOR ASSY.	2							X		
A	WSCT591	HUB / ROTOR ASSY.	2								X	
A	WSCT727AD	HUB / ROTOR ASSY.	2									X

- Note:** TN – tapered spindle (small and big bearing) | TP – parallel spindle (two bearings the same)  
 NSS: Not Sold Separately  
 Hub cap: May vary (Oil hubs, Customer specs and Hub odometer may require different hub caps)
1. Studs may be short or long, check before you order.
  2. The long Nut is also available (32mm); H34-0901. Can be used on long studs with steel wheels.