

ITEM NO.	PART NUMBER	DESCRIPTION	QTY.
1	FU20DB0100	BEAM & CALIPER UNITISED	1
2	40195027	CALIPER DISC BRAKE L/H	1
3	40195028	CALIPER DISC BRAKE R/H	1
4	2935	CAPSCREW - M16-1.5 x 50 - CLASS12.9	12
5	FW473	HUB UNITISED - 10x285 DISC	2
6	BC8434	ROTOR - 45x377 - 90 TEETH POLE	2
7	KH800239	M22 x 1.5 KNURLED STUD - 122mm LONG	20
8	KHDB014	CAP SCREW - M16-2x40 CLASS 12.9	20
9	KH800238	FLANGE NUT- 33mm AF	20
10	KH1897	Hubcap - Unitised Hub	2
11	KH800055	SPRING WASHER, HUB CAP 5/16"	12
12	KH800021	LOCK TAB WASHER - UNITISED AXLE	2
13	KH800122	5/16"-18 UNC x 3/4 BOLT, HUB CAP	12
14	N300200-001	SEAL SHIELD	2
15	BTH-0053	UNITISED BEARING ASSEMBLY	2
16	FHD-046	Unitised Wheel Bearing Warning Decal	2
17	KH47693	SCOTCH SEAL (SKF P/N 47693)	2
18	STP275	CAP - SPINDLE END - UNITISED AXLE	2
19	KHLOCKTAB	LOCK TAB - UNITISED AXLE	2
20	KH800020SG	SPINDLE NUT - UNITISED - SURFACE GROUND	2
21	10002	LENS CAP BADGE FUWA	2
22	CRS.S	INTERNAL ROUND SNAP RING	2

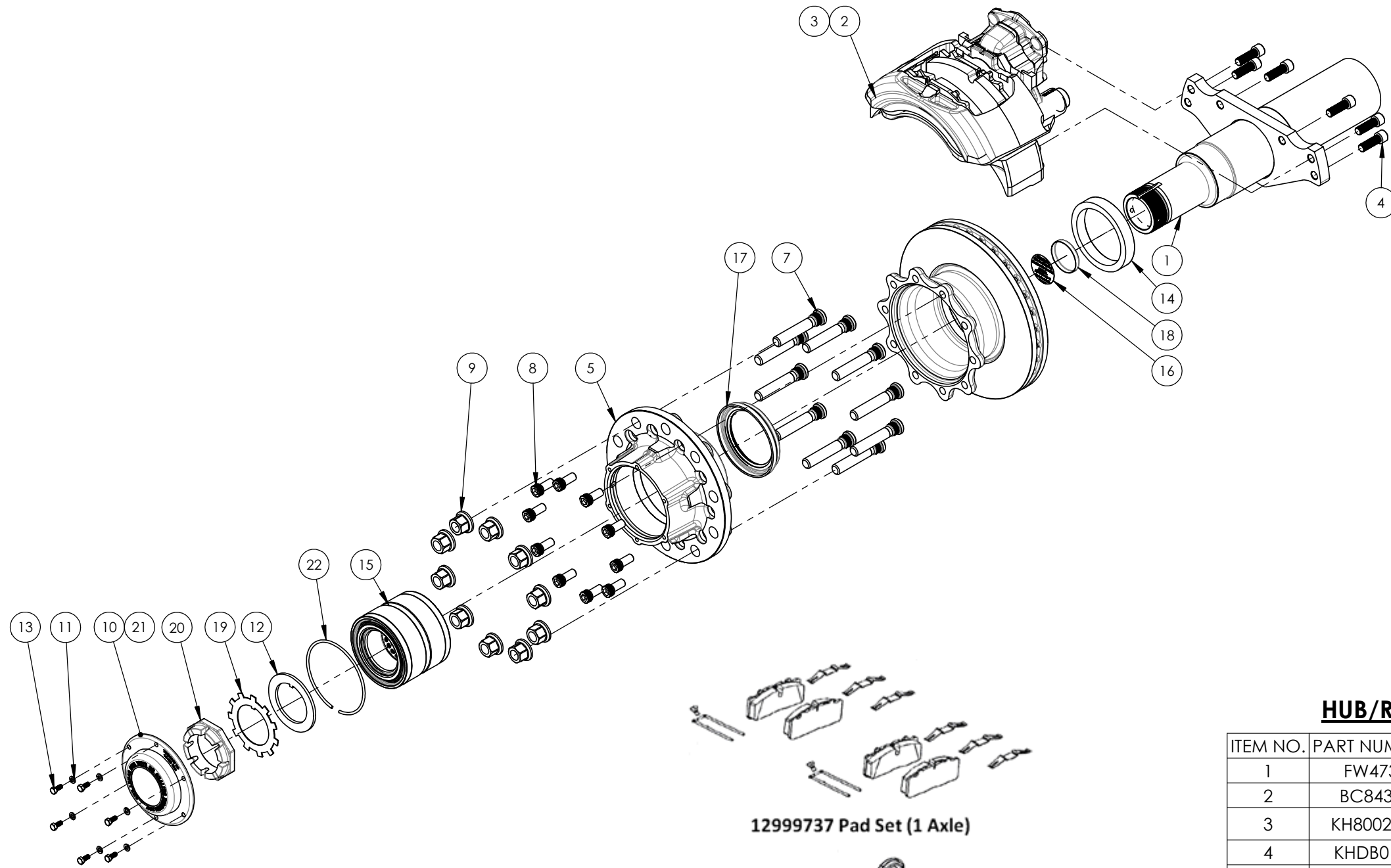

### HUB/ROTOR ASSEMBLY: FWA473-01

ITEM NO.	PART NUMBER	DESCRIPTION	QTY.
1	FW473	HUB UNITISED - 10x285 DISC	1
2	BC8434	ROTOR - 45x377 - 90 TEETH POLE	1
3	KH800239	M22 x 1.5 KNURLED STUD - 122mm LONG	10
4	KHDB014	CAP SCREW - M16-2x40 CLASS 12.9	10
5	KH800238	FLANGE NUT- 33mm AF	10

12999737 Pad Set (1 Axle)

12999776 Seal Kit (1 Caliper)

This Print remains the property of Fuwa K HITCH PtyLtd. All information contained thereon is confidential. It is loaned, subject to return on demand and on express condition that it is not to be copied or used directly or indirectly for any purpose other than the purpose for which it has been loaned to you.



P/N: FHT-001  
Tolerance is standard unless otherwise stated

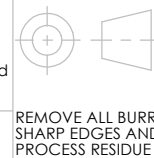

MATERIAL: -

SURFACE FINISH: -

WEIGHT: -

BOM: -

Project No. Revision Level:

Part No. SCALE:1:10

	NAME	SIGNATURE	DATE
DRAWN	D.R		-
CHKD	Z.L		-
APPVD			

Description: **10x285 Unitised Disc Axle Assembly** **KK26UG15L1850NXX**

DIMENSIONS IN MILLIMETRES