



# FUWA K HITCH (Australia) Pty Ltd

ABN 54 078 731 209

## Head Office

### Melbourne

13-21 Bliss Court

Derrimut VIC 3030

Tel. 03 9369 0000

Fax. 03 9369 0100

## Queensland

41 Moreton

Heathwood Qld 4110

Tel. 07 3372 2223

Fax. 07 3372 1022

## Perth

77B Kurnall Road

Welshpool WA 6106

Tel. 08 9350 6470

Fax. 08 9350 6570

## SALES SPEC SHEET

# AXLE KK44



The K Hitch series of **ONE-PIECE FORGED AXLES** are available in a variety of configuration to suit most application.

The following model information is specific to the KK44, but features like induction hardened bearing journals, premium bearings and seals and OE quality brake linings are standard to all FUWA K HITCH axles.

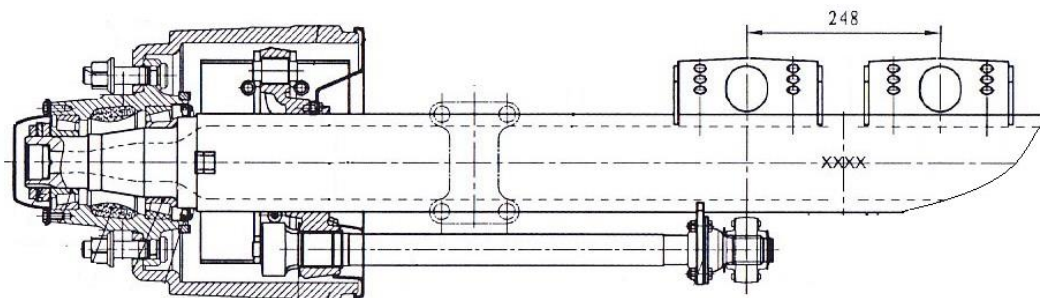

CAPACITY TON	BEARING TYPE	BRAKE TYPE	S-CAM SIZE	S-CAM TYPE	WHEEL END OPTIONS
10.5t	TN	Ø311x190 (12.25"x7.5") GP – RW9/13/2	1-1/2" - 10 Spline	OPEN	10x225 – 17.5" 3 SPOKE-15"

TRACK	C-C BOOSTERS	WEIGHT	ABS	AXLE BEAM SIZE	LUBE
1820	218	278KG*	Poll ring fitted Sensor mounting fitted	Ø127x15	GREASE (OIL ON REQUEST ONLY)
1850	248				

Note\*: Specific configuration KK44 AG 15L 1820 N32



# FUWA K HITCH (Australia) Pty Ltd

ABN 54 078 731 209

## Head Office

### Melbourne

13-21 Bliss Court

Derrimut VIC 3030

Tel. 03 9369 0000

Fax. 03 9369 0100

## Queensland

41 Moreton

Heathwood Qld 4110

Tel. 07 3372 2223

Fax. 07 3372 1022

## Perth

77B Kurnall Road

Welshpool WA 6106

Tel. 08 9350 6470

Fax. 08 9350 6570

## KK44 SERVICE INFORMATION

BULLETIN NUMBER	TOPIC	DESCRIPTION
KPW-002-0110	Warranty	Limitation of Liabilities
KPW-004-0110		LGL’s
KPM-001-0110		Claim Form
KPM-001-0814	Installation	List of all Bulletins which are useful and may need to be referred to when installing a FKH axle.
		Application specific engineering drawings are available upon request.
KPS-002-0413	Parts	Parts View
KPM-004-0310	Maintenance	In service maintenance

## Bulletins:

All Bulletins are on: [www.khitch.com.au](http://www.khitch.com.au)

...or call FKH at your nearest location.

