

PARTS VIEW

KI Axle Lift Kits

KIS (wide bush)

Dual Side Lift Kit – Weld-on (overslung only)

Ref No	PART NO.	DESCRIPTION	QTY
ALL	N100562-003	COMPLETE KIT	1
1	N100521-008	AIRSPRING	2
2	N100561-003	LIFT BRACKET - ARM	2
3	N100561-033	LIFT BRACKET – TAPERED HANGER	2
3	N100561-034	LIFT BRACKET – STRAIGHT HANGER	2
4	N100362-007	WASHER, SPRING 3/8"	4
5	N100362-013	WASHER, SPRING 1/2"	4
6	N100144-001	SET SCREW, 3/8"-16 x 3/4 UNC	4
7	N100161-001	HEX NUT, 1/2"-13 UNC	4

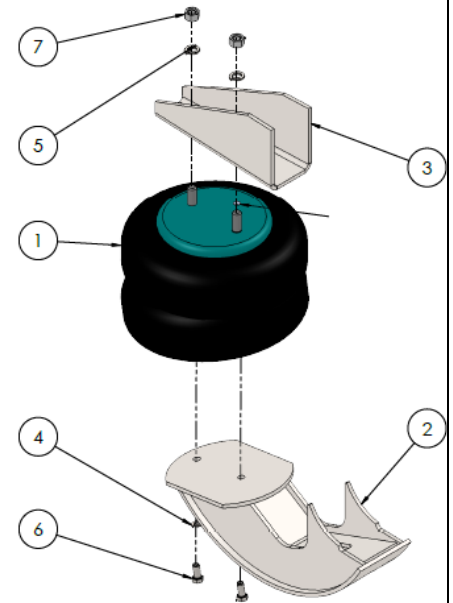

Note: For proper weld-on information, request the installation drawing from FKH engineering.

KIL (narrow bush)

Dual Side Lift Kit – Weld-on (overslung only)

Ref No	PART NO.	DESCRIPTION	QTY
ALL	N100562-003	COMPLETE KIT	1
1	N100521-008	AIRSPRING	2
2	N100561-004	LIFT BRACKET - ARM	2
3	N100561-033	LIFT BRACKET	2
4	N100362-007	WASHER, SPRING 3/8"	4
5	N100362-013	WASHER, SPRING 1/2"	4
6	N100144-001	SET SCREW, 3/8"-16 x 3/4 UNC	4
7	N100161-001	HEX NUT, 1/2"-13 UNC	4

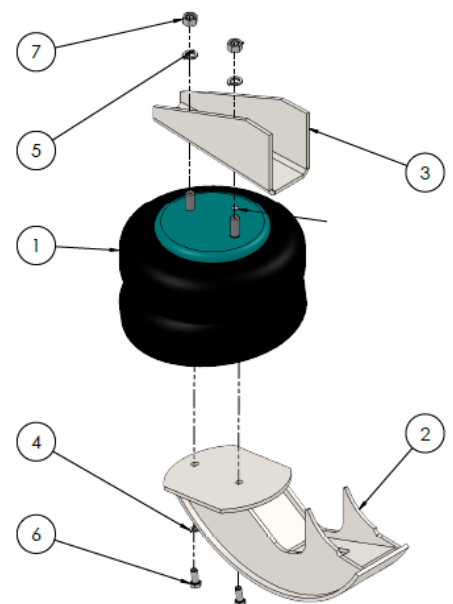

Note: For proper weld-on information, request the installation drawing from FKH engineering.